

MX-500-SERIES

Monitoring Switch Kits

Switch kits are field installed in the inactive hinge pad of rim mount exit devices, mortise exit devices, concealed vertical rod exit devices and surface vertical rod exit devices

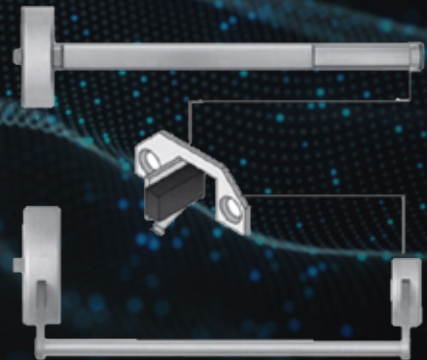

Features

- Include a SPDT Switch Assembly with Wire Leads
- Electromagnetic Lock Release
- Request-to-Exit
- Alarm Shut or Alarm Activation

Specification

Model	MX-500-SERIES
Switch Contact	SPDT, 5 Amp @ 30VDC

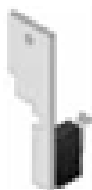

MX-VDS511-K



MX-VDS512-K



MX-EDS514-KD

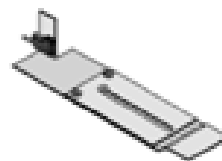

MX-SAS527-K



MX-YS531-K